

Courtesy Of Kenton T King Of MaxWell Progressive

\$275,000 - 8 26328 Twp Road 511, Rural Parkland County

MLS® #E4430571

\$275,000

0 Bedroom, 0.00 Bathroom,
Rural on 2.02 Acres

West Glen Estates, Rural Parkland County, AB

Get started on your dream home build at West Glen Estates where youâ€™ll get tremendous value with this 2 acre lot! This amazing 74 acre subdivision is located in Parkland County just west of Hwy 60 on the corner of Graminia & Sanctuary Road. Gentle rolling terrain, an abundance of trees, paved road, and bordered on two sides by environmentally protected wetlands & Ducks Unlimited nesting projects. Graminia School (K-9) is located 5 Km West on Graminia Road, Nisku and the Edmonton International Airport are only 15 minutes away, and the Town of Devon is only 5 minutes away with volunteer fire department, full service RCMP facility, hospital & ambulance service, with many more amenities and services available. PLUS major tourist attractions such as RAD Torque Raceway, U of A Botanic Gardens, Rabbit Hill Snow Resort, Canada Petroleum Discover Centre, Clifford E. Lee Nature Sanctuary, Devon Voyageur Park and Prospectors Point are only minutes away. A beautiful place to call home!

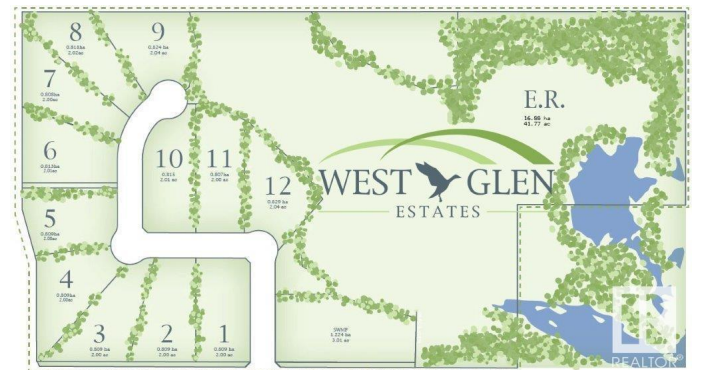

Essential Information

MLS® #	E4430571
Price	\$275,000
Bathrooms	0.00

Acres	2.02
Type	Rural
Sub-Type	Vacant Lot/Land
Status	Active

Community Information

Address	8 26328 Twp Road 511
Area	Rural Parkland County
Subdivision	West Glen Estates
City	Rural Parkland County
County	ALBERTA
Province	AB
Postal Code	T7Y 1E1

Exterior

Exterior Features Airport Nearby, Environmental Reserve, Golf Nearby, Rolling Land

Additional Information

Date Listed	April 11th, 2025
Days on Market	67
Zoning	Zone 90

DATA IS DEEMED RELIABLE BUT IS NOT GUARANTEED ACCURATE BY THE REALTORS® ASSOCIATION OF EDMONTON. COPYRIGHT 2025 BY THE REALTORS® ASSOCIATION OF EDMONTON. ALL RIGHTS RESERVED. Trademarks are owned or controlled by the Canadian Real Estate Association (CREA) and identify real estate professionals who are members of CREA (REALTOR®, REALTORS®) and/or the quality of services they provide (MLS®, Multiple Listing Service®)

Listing information last updated on June 17th, 2025 at 8:47pm MDT