

# \$619,000 - B28 Golden Crescent, Rural Leduc County

MLS® #E4430937

**\$619,000**

4 Bedroom, 2.50 Bathroom, 1,907 sqft  
Rural on 0.50 Acres

Golden Days, Rural Leduc County, AB

This beautifully updated 1,900+ sq. ft. home blends modern comfort with serene lakeside living. With 4 bedrooms and 2.5 baths, it features quartz countertops, luxury vinyl tile, plush carpet, and hardwood floors throughout. The chef’s kitchen offers stainless steel appliances, stylish fixtures, and generous workspace. A wood-burning fireplace anchors the cozy, light-filled living room. The spacious primary suite includes a walk-in closet and a relaxing ensuite. Surrounded by trees, the home offers both natural light and privacy. Upgrades include a new furnace, hot water tank, A/C, reverse osmosis, and whole-house water filtration. Enjoy nearby walking trails and shared access to the community dock, just a short stroll to the lake. The heated, oversized double garage provides excellent storage. With a playground, pickleball court, and ball diamond nearby, this move-in ready home offers the full package “inside and out!”

Built in 1995

## Essential Information

|            |           |
|------------|-----------|
| MLS® #     | E4430937  |
| Price      | \$619,000 |
| Bedrooms   | 4         |
| Bathrooms  | 2.50      |
| Full Baths | 2         |

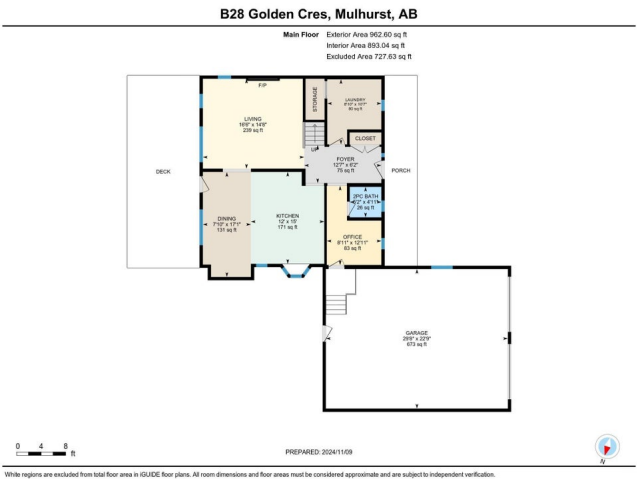

|                |                        |
|----------------|------------------------|
| Half Baths     | 1                      |
| Square Footage | 1,907                  |
| Acres          | 0.50                   |
| Year Built     | 1995                   |
| Type           | Rural                  |
| Sub-Type       | Detached Single Family |
| Style          | 2 Storey               |
| Status         | Active                 |

### Community Information

|             |                     |
|-------------|---------------------|
| Address     | B28 Golden Crescent |
| Area        | Rural Leduc County  |
| Subdivision | Golden Days         |
| City        | Rural Leduc County  |
| County      | ALBERTA             |
| Province    | AB                  |
| Postal Code | T0C 2P0             |

### Amenities

|          |              |
|----------|--------------|
| Features | R.V. Storage |
|----------|--------------|

### Interior

|                   |                           |
|-------------------|---------------------------|
| Interior Features | ensuite bathroom          |
| Heating           | Forced Air-1, Natural Gas |
| Fireplace         | Yes                       |
| Stories           | 2                         |
| Has Basement      | Yes                       |
| Basement          | None, No Basement         |

### Exterior

|                   |                                 |
|-------------------|---------------------------------|
| Exterior          | Wood                            |
| Exterior Features | Lake Access Property, Treed Lot |
| Construction      | Wood                            |
| Foundation        | Concrete Perimeter              |

### Additional Information

|                |                  |
|----------------|------------------|
| Date Listed    | April 15th, 2025 |
| Days on Market | 17               |
| Zoning         | Zone 95          |

DATA IS DEEMED RELIABLE BUT IS NOT GUARANTEED ACCURATE BY THE REALTORS® ASSOCIATION OF EDMONTON. COPYRIGHT 2025 BY THE REALTORS® ASSOCIATION OF EDMONTON. ALL RIGHTS RESERVED.Trademarks are owned or controlled by the Canadian Real Estate Association (CREA) and identify real estate professionals who are members of CREA (REALTOR®, REALTORS®) and/or the quality of services they provide (MLS®, Multiple Listing Service®)

Listing information last updated on May 2nd, 2025 at 2:17pm MDT