

Courtesy Of Jatinder Singh Of Initia Real Estate

\$164,999 - 134 5515 7 Avenue, Edmonton

MLS® #E4438294

\$164,999

1 Bedroom, 1.00 Bathroom, 607 sqft

Condo / Townhouse on 0.00 Acres

Charlesworth, Edmonton, AB

THIS ONE BEDROOM AND ONE BATHROOM APARTMENT IS LOCATED IN THE COMMUNITY OF CHARLESWORTH. THIS WELL MAINTAINED APARTMENT IS LOCATED ON THE MAIN FLOOR AND CLOSE TO THE MAIN ENTRANCE. THIS APARTMENT COMES WITH ONE TITLED PARKING STALL WHICH IS JUST FEW STEPS FROM THE WINDOW. IT IS PERFECT FOR THE FIRST TIME HOME-BUYERS. IT IS LOCATED CLOSE TO SEVERAL AMENITIES. MUST SEE...PRICED TO SELL...

Built in 2014

Essential Information

MLS® #	E4438294
Price	\$164,999
Bedrooms	1
Bathrooms	1.00
Full Baths	1
Square Footage	607
Acres	0.00
Year Built	2014
Type	Condo / Townhouse
Sub-Type	Lowrise Apartment
Style	Single Level Apartment
Status	Active

134-5515 7 Ave SW, Edmonton, AB

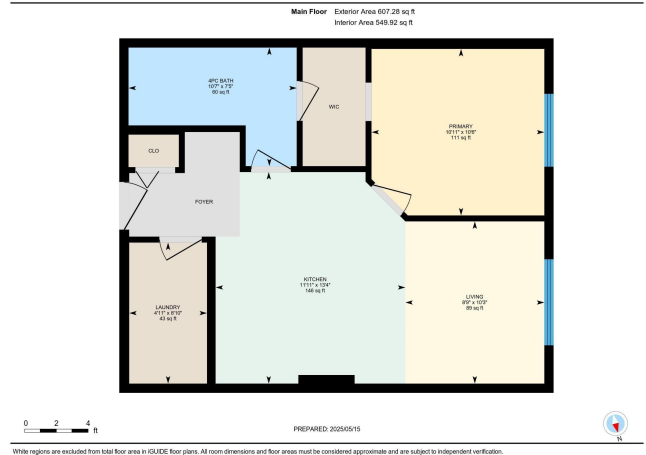

134-5515 7 Ave SW, Edmonton, AB

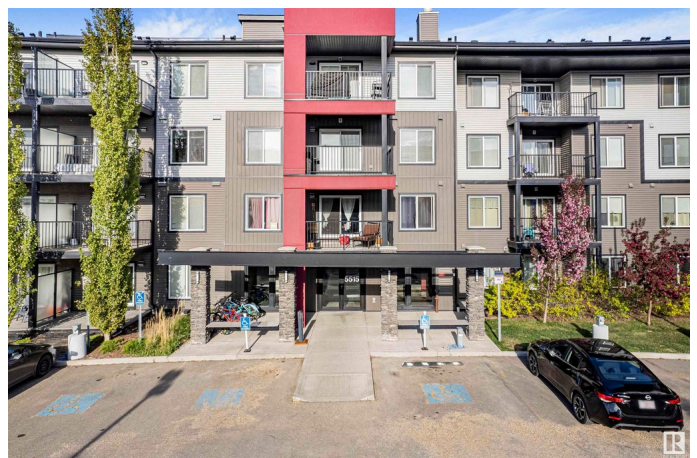
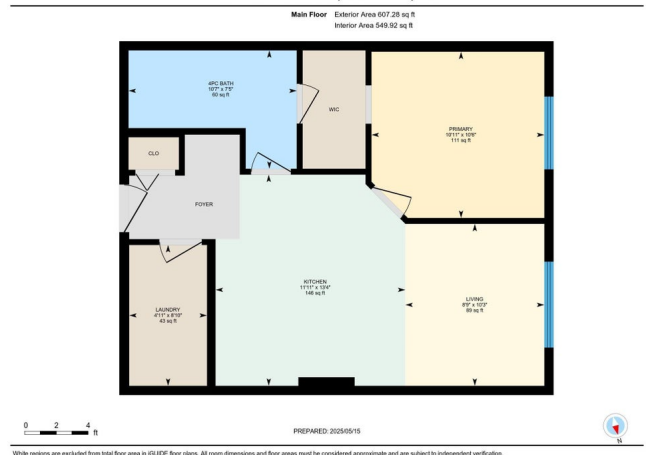

Community Information

Address	134 5515 7 Avenue
Area	Edmonton
Subdivision	Charlesworth
City	Edmonton
County	ALBERTA
Province	AB
Postal Code	T6X 2A8

Amenities

Amenities	On Street Parking, Carbon Monoxide Detectors, Detectors Smoke, No Animal Home, No Smoking Home, Parking-Visitor, Secured Parking
Parking Spaces	1
Parking	Stall

Interior

Interior Features	ensuite bathroom
Appliances	Dishwasher-Built-In, Dryer, Microwave Hood Fan, Refrigerator, Stove-Electric, Washer, Window Coverings
Heating	Forced Air-1, Natural Gas
# of Stories	4
Stories	4
Has Basement	Yes
Basement	None, No Basement

Exterior

Exterior	Wood, Stone, Vinyl
Exterior Features	Airport Nearby, Playground Nearby, Public Transportation, Schools
Roof	Asphalt Shingles
Construction	Wood, Stone, Vinyl
Foundation	Concrete Perimeter

Additional Information

Date Listed	May 23rd, 2025
Days on Market	132
Zoning	Zone 53
Condo Fee	\$293

DATA IS DEEMED RELIABLE BUT IS NOT GUARANTEED ACCURATE BY THE REALTORS® ASSOCIATION OF EDMONTON. COPYRIGHT 2025 BY THE REALTORS® ASSOCIATION OF EDMONTON. ALL RIGHTS RESERVED. Trademarks are owned or controlled by the Canadian Real Estate Association (CREA) and identify real

estate professionals who are members of CREA (REALTOR®®, REALTORS®®) and/or the quality of services they provide (MLS®®, Multiple Listing Service®®)

Listing information last updated on October 2nd, 2025 at 4:18pm MDT